

SEWER BUILDERS RETURN

I HEREBY CERTIFY that the within connection enters lot at a point 7' feet South of North line of said lot and was properly made by me on July 27 day of July in conformity with the specifications of Sanitary Engineering Department; that the connection was made with the recorded Y branch or connection for said lot without opening or in any way injuring the main sewer; that said connection was laid to a true and proper grade, and constructed of sound and substantial 5' sewer pipe, with the joints properly cemented and tight and that the whole was left in clean and good condition.

Measurement used was 177 feet from M.H. - S Depth of connection at point of tap 8' 6"
 Depth of connection at lot line 8' Connection in house made to Stack Linke Drain
 Roofwater ~~is~~ will be conducted under my contract to To Street
E. H. Erhardt
 Licensed Sewer Builder

Approved Hymetz Inspector

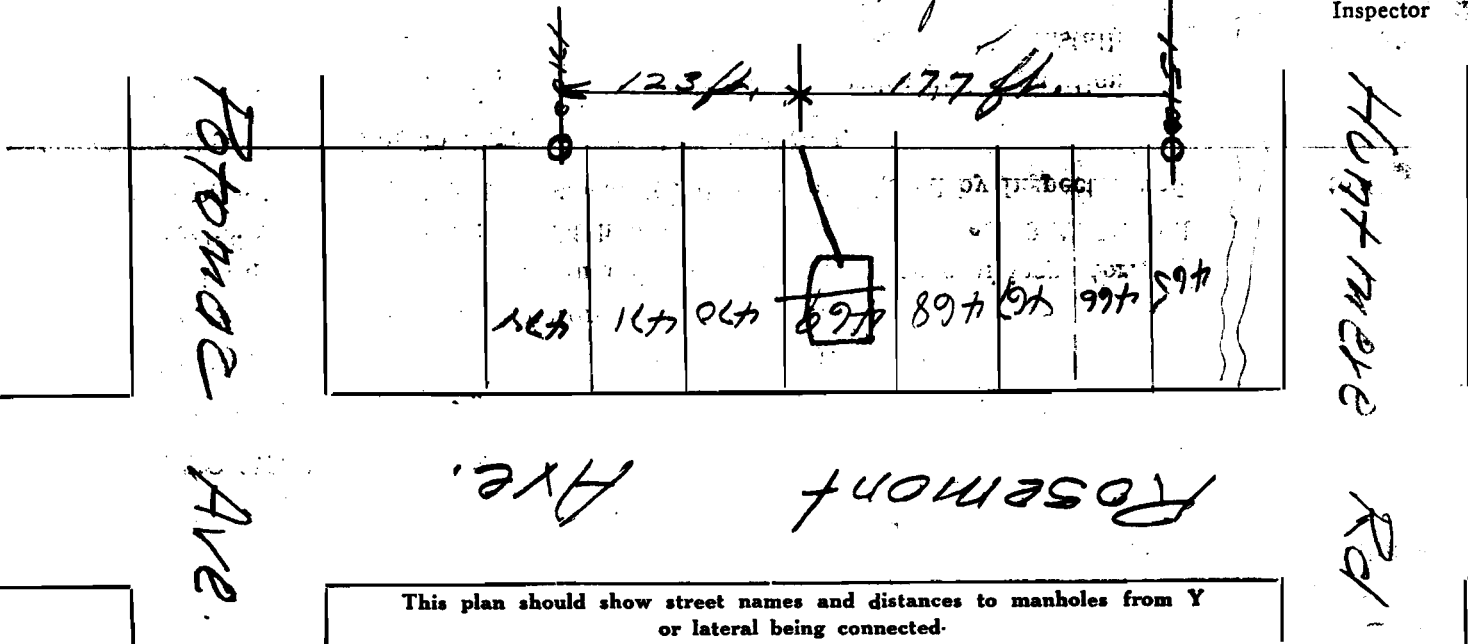

Permit No. 36

[Signature]
 Sewer District

SEWER CONNECTION

Lot No. 469
 Subdivision Wheeler Subdiv
Pringle Subdiv
 Street Rosewood

Recorded in Sewer Book

Vol. 3, Pg. 126

1520
13223
177