

SEWER BUILDERS RETURN

I HEREBY CERTIFY that the within connection enters lot at a point 19' feet NE line of said lot and was properly made by me on May 15 day of May in conformity with the specifications of Sanitary Engineering Department; that the connection was made with the recorded Y branch or connection for said lot without opening or in any way injuring the main sewer; that said connection was laid to a true and proper grade, and constructed of sound and substantial 5' sewer pipe, with the joints properly cemented and tight and that the whole was left in clean and good condition.

Measurement used was 113 feet from MH - N Depth of connection at point of tap 10"  
 Depth of connection at lot line 5 1/2 Connection in house made to Stack Sink Cellar  
 Roofwater ~~will be~~ is (not) conducted under my contract to Ernest E. H. Ehrhardt  
 Licensed Sewer Builder

Approved J. J. Perkins Inspector

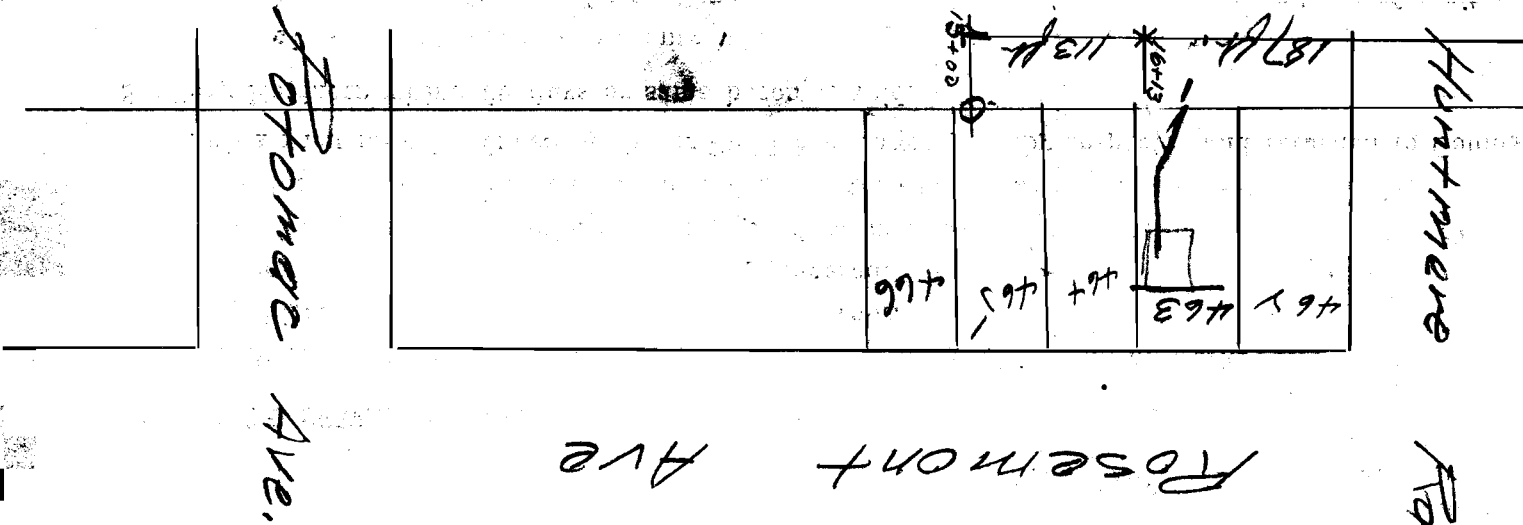

This plan should show street names and distances to manholes from Y or lateral being connected.

Permit No. 40

Aurora  
Sewer District

SEWER CONNECTION

Lot No. 463

Subdivision Wickham  
Rocky etc. sub. div.  
 Street Rosemont

Recorded in Sewer Book

Vol. 3, Page 27