

SEWER BUILDERS RETURN

I HEREBY CERTIFY that the within connection enters lot at a point 26' feet north of south line of said lot and was properly made by me on 29th day of Sept. 1926 in conformity with the specifications of Sanitary Engineering Department; that the connection was made with the recorded Y branch or connection for said lot without opening or in any way injuring the main sewer; that said connection was laid to a true and proper grade, and constructed of sound and substantial 5" vitrified sewer pipe, with the joints properly cemented and tight and that the whole was left in clean and good condition.

Measurement used was 3 1/2' feet from north M.H. Depth of connection at point of tap 8'
Depth of connection at lot line 8' Connection in house made to house drain

Roofwater will be conducted under my contract to Williams + Williams P.C. & William
is (not) Licensed Sewer Builder

Approved 9-29-26 Ray K. Smith Inspector

Hankenberg Ave

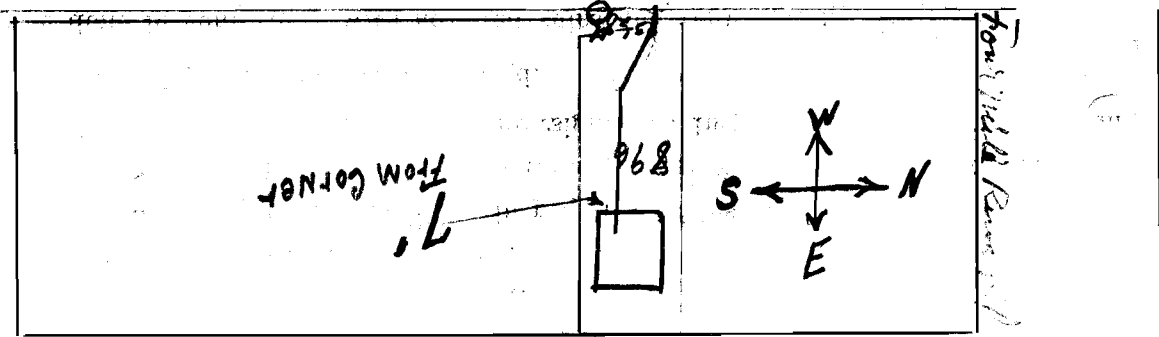

This plan should show street names and distances to manholes from Y or lateral being connected.

Permit No. 56
Washburn
Sewer District

SEWER CONNECTION

Lot No. 896

Subdivision Broadview

Street Reed Carnegie Ave

Recorded in Sewer Book

Vol. 4, Pg. 31