

SEWER BUILDERS RETURN

I HEREBY CERTIFY that the within connection enters lot at a point 33' 2" feet south of north line of said lot and was properly made by me on 11th day of Aug., 1927. in conformity with the specifications of Sanitary Engineering Department; that the connection was made with the recorded Y branch or connection for said lot without opening or in any way injuring the main sewer; that said connection was laid to a true and proper grade, and constructed of sound and substantial 5" vitrified sewer pipe, with the joints properly cemented and tight and that the whole was left in clean and good condition.

Measurement used was 84' feet from south N.H. Depth of connection at point of tap 9' Depth of connection at lot line 6' 6" Connection in house made to Said street drain will be conducted under my contract to Roofwater

W. W. Hoffmann
Licensed Sewer Builder
Approved 8-11-27 Ray B. Buckell
Inspector

Wickliffe Blvd.

Dakdale

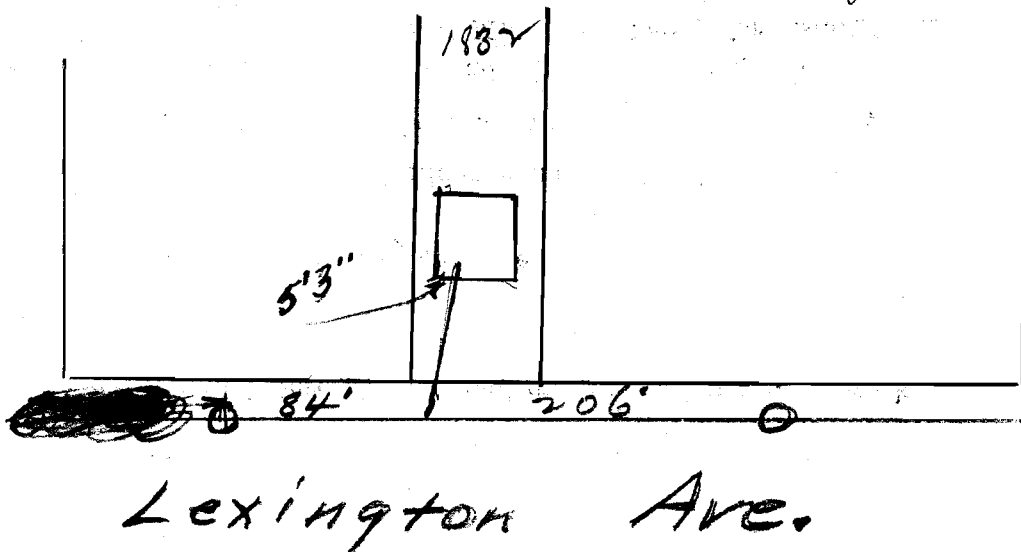

This plan should show street names and distances to manholes from Y or lateral being connected.

Permit No. 69
Wickliffe
Sewer District

SEWER CONNECTION

Lot No. 1832
Subdivision Wickliffe - Commercial
Street Lexington Place

Recorded in Sewer Book

Vol. 3, Pg. 143

690
484
206
84
400