

SEWER BUILDERS RETURN

I HEREBY CERTIFY that the within connection enters lot at a point 8' feet east of
west line of said lot and was properly made by me on 11th day of August, 1927
in conformity with the specifications of Sanitary Engineering Department; that the connection was made with the recorded Y
branch or connection for said lot without opening or in any way injuring the main sewer; that said connection was laid to a
true and proper grade, and constructed of sound and substantial 5" vitrified sewer pipe, with the joints properly
cemented and tight and that the whole was left in clean and good condition.

Measurement used was 7.5' feet from east M. H. Depth of connection at point of tap 8'
Depth of connection at lot line 6' Connection in house made to house drain

Roofwater ~~is~~ (not) conducted under my contract to surface

M. H. Mitchell
Licensed Sewer Builder

Approved 8-11-27 Ray B. Burtell
Inspector

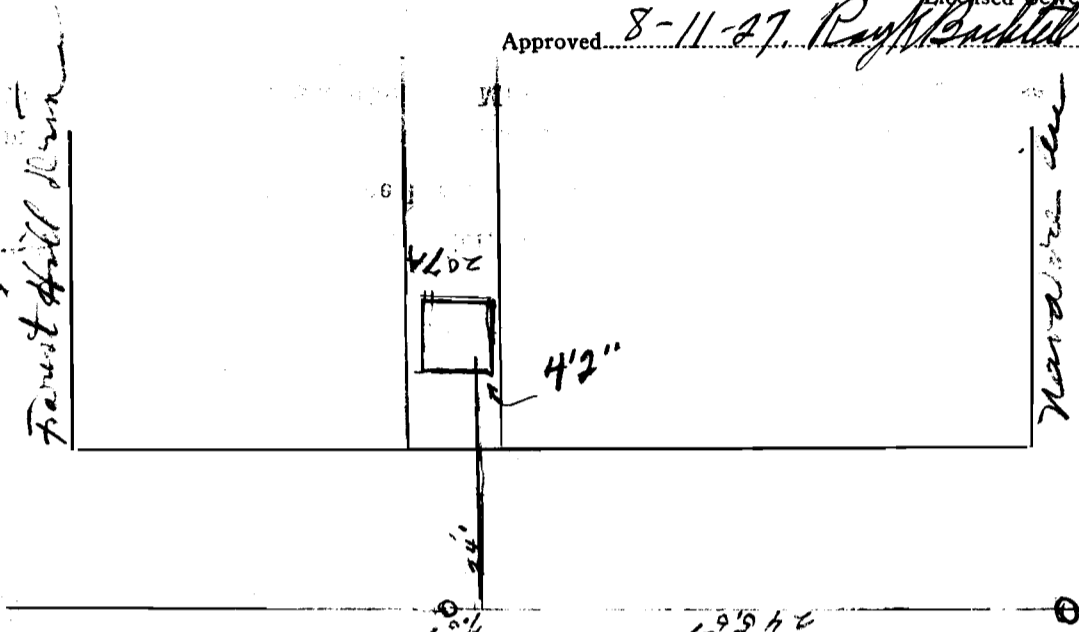

This plan should show street names and distances to manholes from Y or lateral being connected.

✓
Permit No. 73
Wickliffe Annex
Sewer District

SEWER CONNECTION

Lot No. 207A
Subdivision Wickliffe Annex
Street Elmwood

Recorded in Sewer Book

Vol. 3, Pg. 138