

SEWER BUILDERS RETURN

I HEREBY CERTIFY that the within connection enters lot at a point 8' feet North from
South line of said lot and was properly made by me on 16th day of Nov., 1927
in conformity with the specifications of Sanitary Engineering Department; that the connection was made with the recorded Y
branch or connection for said lot without opening or in any way injuring the main sewer; that said connection was laid to a
true and proper grade, and constructed of sound and substantial 5" vitrified sewer pipe, with the joints properly
cemented and tight and that the whole was left in clean and good condition.

Measurement used was 7' 5" feet from Manhole. Depth of connection at point of tap 8' 6"
Depth of connection at lot line 6' Connection in house made to 4" soil pipe drain

Roofwater is (not) conducted under my contract to Sanitary sewer - to surface
Mac Donald & Mc Ginnell
Licensed Sewer Builder
Approved 11-18-27 Ray K. Rickett
Inspector

Handwritten signature

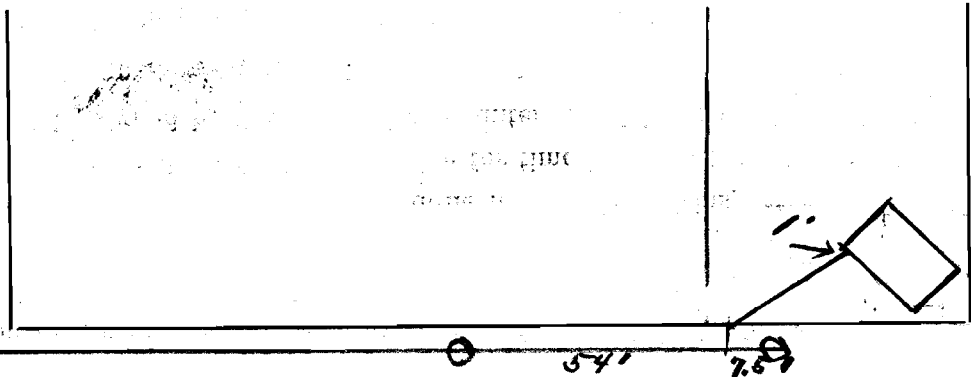

Four Mile Run Rd
This plan should show street names and distances to manholes from Y
or lateral being connected.

Permit No. 92
Anscombe
Sewer District

SEWER CONNECTION

Lot No. 934
Subdivision Wickliffe Broadview
Street Four Mile Run Rd

Recorded in Sewer Book
Vol. 3, Pg. 705

SEWER BUILDERS RETURN

I HEREBY CERTIFY that the within connection enters lot at a point 5' feet from south East Corner line of said lot and was properly made by me on June 21 day of 1928 in conformity with the specifications of Sanitary Engineering Department ; that the connection was made with the recorded Y branch or connection for said lot without opening or in any way injuring the main sewer ; that said connection was laid to a true and proper grade, and constructed of sound and substantial 5" vitrified sewer pipe, with the joints properly corked with jute and cement and that the whole was left in clean and good condition.

Measurement used was 7'-5" feet from M.H. Depth of connection at point of tap 8'-6"
 Depth of connection at lot line 7'-8" Connection in house made to Sanitary Plumbing
 Roofwater ~~will be~~ conducted under my contract to: curb or street
Mac Donald & Macdonald
Macdonald

Duplicate
 Approved 6-28-28 Ray B. Bechtel
 Licensed Sewer Builder
 Inspector

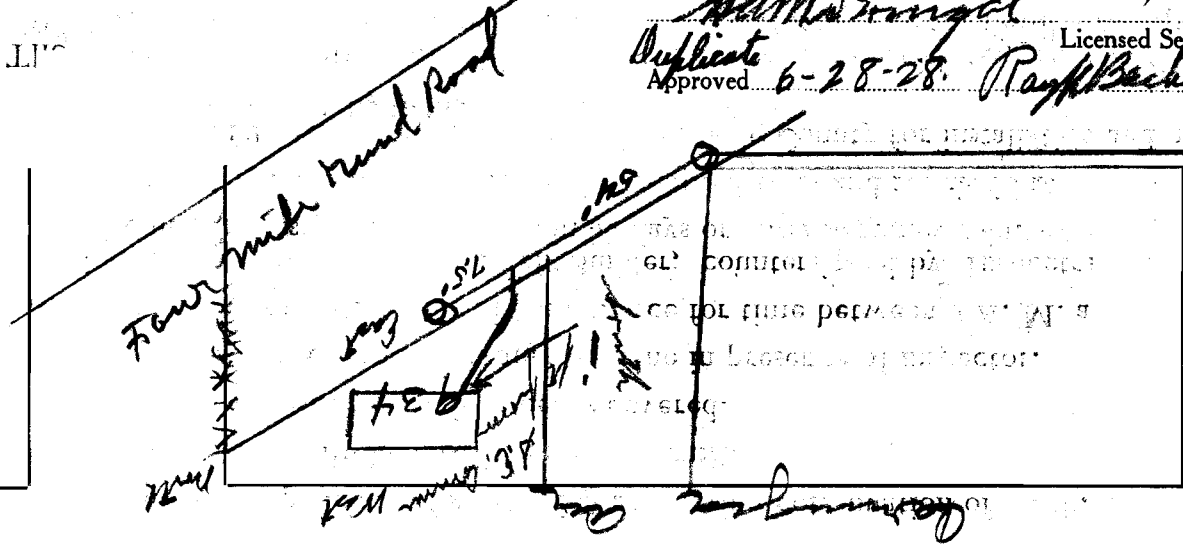

This plan should show street names and distances to manholes from Y or lateral being connected.

92

Permit No. 92

Amherst
 Sewer District

SEWER CONNECTION

Lot No. 934

Subdivision Wickliffe - Bunker

Street Four mile Run Road

Recorded in Sewer Book

Vol. 3, Pg. 25

Original