

SEWER BUILDERS RETURN

I HEREBY CERTIFY that the within connection enters lot at a point 39' 4" feet north of south line of said lot and was properly made by me on 7th day of Oct., 1927

in conformity with the specifications of Sanitary Engineering Department; that the connection was made with the recorded Y branch or connection for said lot without opening or in any way injuring the main sewer; that said connection was laid to a true and proper grade, and constructed of sound and substantial 5" vit. sewer pipe, with the joints properly cemented and tight and that the whole was left in clean and good condition.

Measurement used was 89' feet from north M.H. Depth of connection at point of tap 7' 9"

Depth of connection at lot line 6' 6" Connection in house made to house drain

Roofwater ~~is~~ is (not) conducted under my contract to house drain

MacDonald & McBrugal
Licensed Sewer Builder
Approved 10-1-27 Ray McWhittell
Inspector

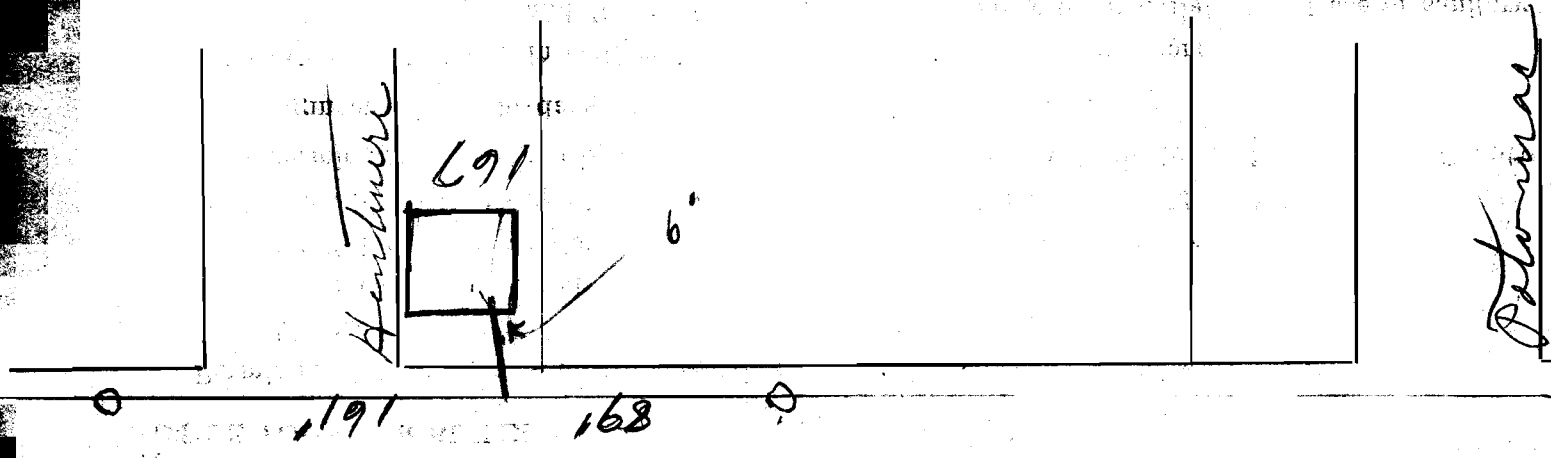

This plan should show street names and distances to manholes from Y or lateral being connected.

Permit No. 95
Constructors
Sewer District
SEWER CONNECTION
Lot No. 167
Subdivision Pargate
Street Pargate
Recorded in Sewer Book
Vol. 3, Pg. 111